



Center for English as a Second Language (CESL) Southern Illinois University (SIU) Carbondale, Illinois, USA



Make friends from all over the world in the USA!





Cultural Immersion Program (CIP)

Experience **4 weeks** of global diversity while living in a welcoming American town. Learn more about our CIP experience here:



1- CIP SCHEDULE



2- CIP ALBUM



3- CIP BUDGET



4- LOGISTICS

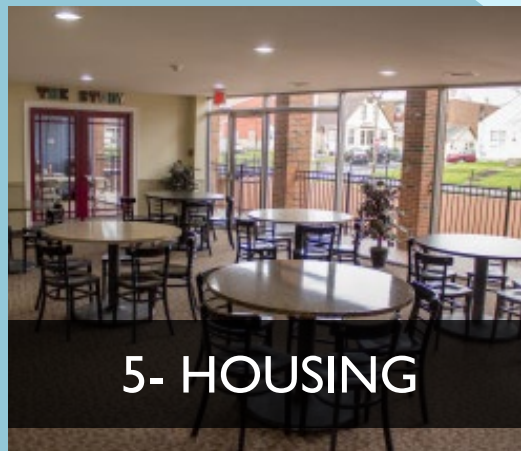

5- HOUSING



6- APPLICATION











CIP Schedule Example

- ✓ 3 hours of class in the mornings from Monday to Friday
- ✓ 5 hours of cultural immersion activities each week
- ✓ This is an example of an August program. Activities may vary depending on local event schedules.



CESL Activity Calendar

Sunday	Monday	Tuesday	Wednesday	Thursday	Friday	Saturday
Week 1 <u>Airport Pick Up</u>	Welcome Party Carbondale & SIU Tours 			American Football Game 		
Week 2			Conversation Hour W/ SIU Students 		Local Music Concert 	
Week 3		Game Hour with SIU Students 		Fall Colors Hike & BBQ 		
Week 4			Apple Festival & Rides 		Graduation Ceremony 	St Louis & Airport Trip 



CIP Photo Album

For more pictures, visit us at https://www.facebook.com/cesl.siuc/photos_by



Conversation Partners



American Football



Outdoor Concerts



Forest Hikes



St. Louis Trip



Game Nights



Budget

✓ Please refer to the attached proposal for details.

4-Week Program Tuition & Fees	Charges Per Student
<i>Application Fee</i>	<i>Waived</i>
Tuition	\$712.50
Class Materials Fee	\$125
Activity Fee	\$275
SIU Student ID Card	\$15
Sports Complex Fee	\$72
Local Bus Pass	\$30
Other Campus Fees	\$253
<i>Health Insurance (proof of coverage needed)</i>	<i>Waived</i>
Tuition & Fees TOTAL:	\$1482.50
Living Expenses (vary by choice)	Charges Per Student
Housing (Saluki or Ambassador Hall, choose one)	\$400 or \$500
Estimated Food budget	\$500
Airport Ride (MWA local airport only)	Free
Living Expenses TOTAL:	\$900+



Logistics & Requirements

- ✓ Immigration: ESTA visa waiver or existing B-visa
- ✓ English Level: +450 TOEIC or equivalent
- ✓ Arrival: August 16 / Departure: September 13
- ✓ Airport: MWA in Marion, IL via Chicago using Contour Airlines

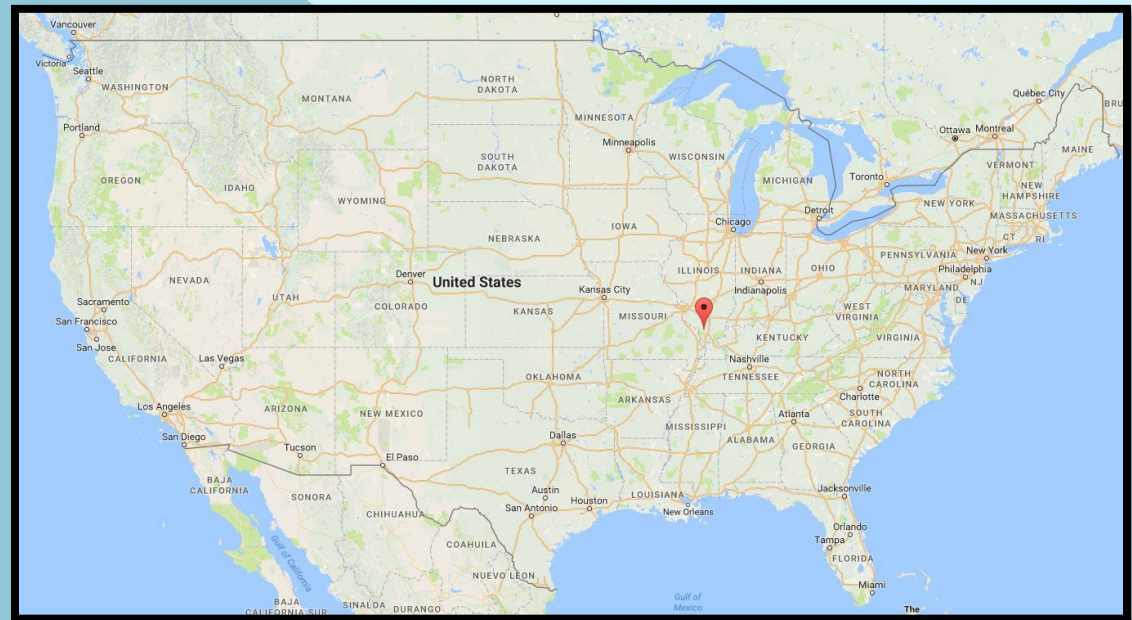



Housing

<https://ambassadorhousing.com/gallery>

Both dorms are across the street from the SIU campus and host American and international students. The dorms also offer many activities. The main difference is sharing the bathroom with 1 suitemate (AH) or several people (SH)



Ambassador Hall (\$500)



Saluki Hall (\$400)

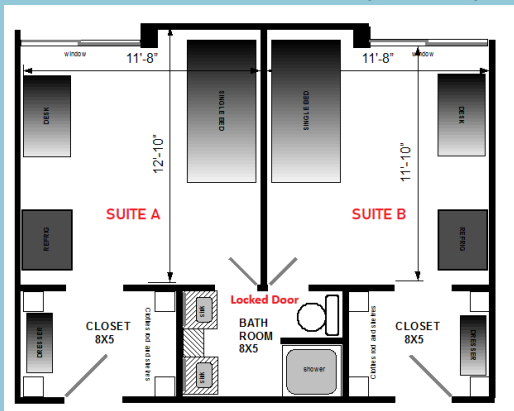



Application Procedures

- ✓ Application Deadline: July 1, 2025
- ✓ Fill out the short online application on our website:
<https://cesl.siu.edu/admission/apply-now.php>
- ✓ We will start guiding you via email once we receive your application
- ✓ Questions? We welcome your emails: cesl@siu.edu





More info about CESL at SIU



Our center:

CESL has over 60 years of experience offering intensive English classes and cultural immersion programs to students from all over the world. If you like friendly people and fun activities, this is the program for you!

<https://cesl.siu.edu/about/>



Our university:

SIU is an R-1 doctoral research university offering over 40 doctoral degrees, 80 master's degrees, and 100+ undergraduate degrees. The beautiful campus covers +1,100 acres, with amenities such as a farm, a forest, and a lake.



Our location:

Carbondale is a friendly and safe town with a low cost of living and spacious housing. Our Shawnee National Forest is the perfect playground for outdoor activities. Weekend trips to Chicago, Nashville, or St Louis complete the experience.



CESL's Faculty & Staff

All CESL faculty members have:

- ✓ A Master's degree in TESOL
- ✓ Experience living in other countries
- ✓ Fluency in several different languages
- ✓ Deep expertise with all English skills & levels
- ✓ Usual feedback: "Best teacher I've ever had"
- ✓ Very supportive staff assist student outside class



Kathryn Carpenter

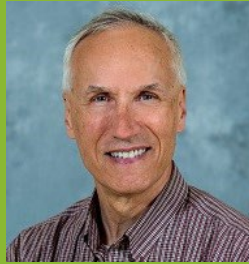

William Hellriegel



Stacie Lawley



Lilia Angel-Post

Questions?

E-mail: cesl@siu.edu

Website: <http://cesl.siu.edu>

Facebook: <https://www.facebook.com/cesl.siu/>

YouTube: <https://www.youtube.com/@ceslsiucenterforenglishasa9279>

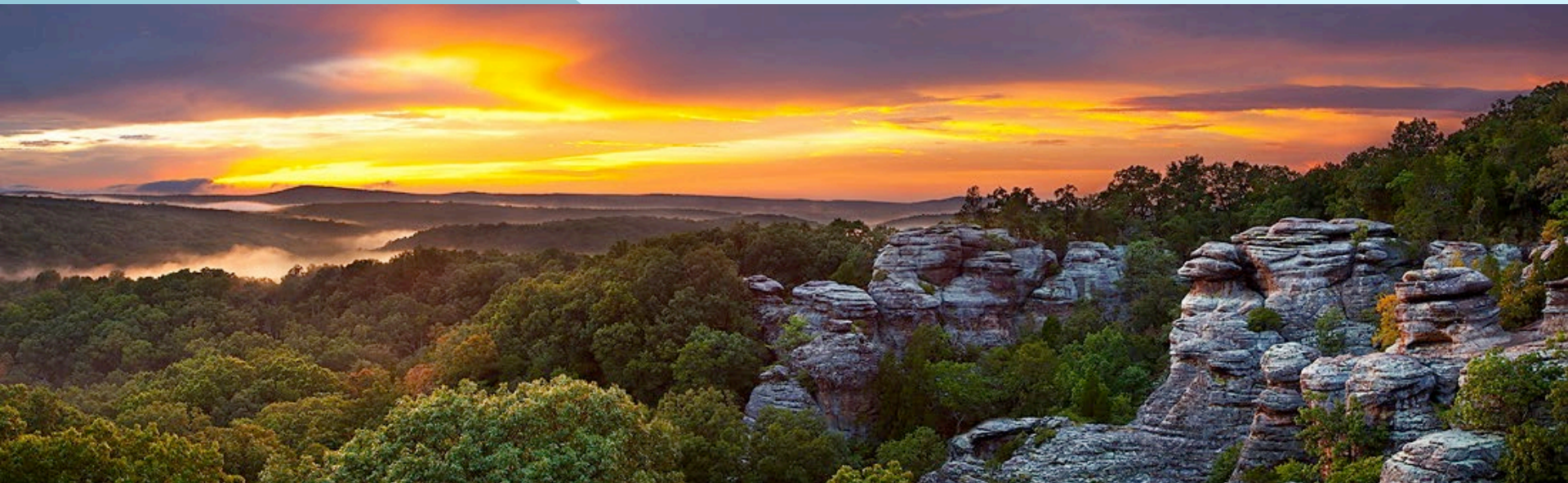

SOUTHERN ILLINOIS UNIVERSITY
**CENTER FOR ENGLISH
AS A SECOND LANGUAGE**